

DIRECTREC

The stylish professional...

The DR-2000 Executive Kit and DR-1000 Dictation Kit form Olympus's new 'Directrec' range of desk-based digital dictation devices. Stylish and easy to use, the intuitive design is perfect for both left- or right-handed users. No matter how long you dictate, the Directrecs are the perfect choice.

Its neat design and stunning performance guarantees that the DR-series will be head and shoulders above its rivals and, as it records directly to a PC, there is no need to worry about storage capabilities or purchasing additional accessories.

Combining simplicity with innovation

The DR-2000 is operated using the popular slide switch control whilst the DR-1000 incorporates a pointing device for dictation control and navigating around your PC. An optional audible 'command beep' on both models ensures that recording is equally easy for the visually impaired.

Crystal clear quality

The Directrec's highly sensitive microphone provides exceptional recording quality whether it is used in dictation mode or in a conference environment. The clever design ensures that the speaker is not obstructed when in use, thus supplying outstanding play-back results. Both models are capable of operating at a high volume – useful for enhancing performance in a noisy environment.

Both models record data in DSS (Digital Speech Standard) directly to a PC and the built-in speaker allows users to confirm the recorded data.

Devices are available either with or without DSS software for full and easy integration into workflow systems. Kits that comprise of a Directrec and DSS software, will be widely available through the Pro-line and retail network.

DR-1000

DR-2000





System Overview

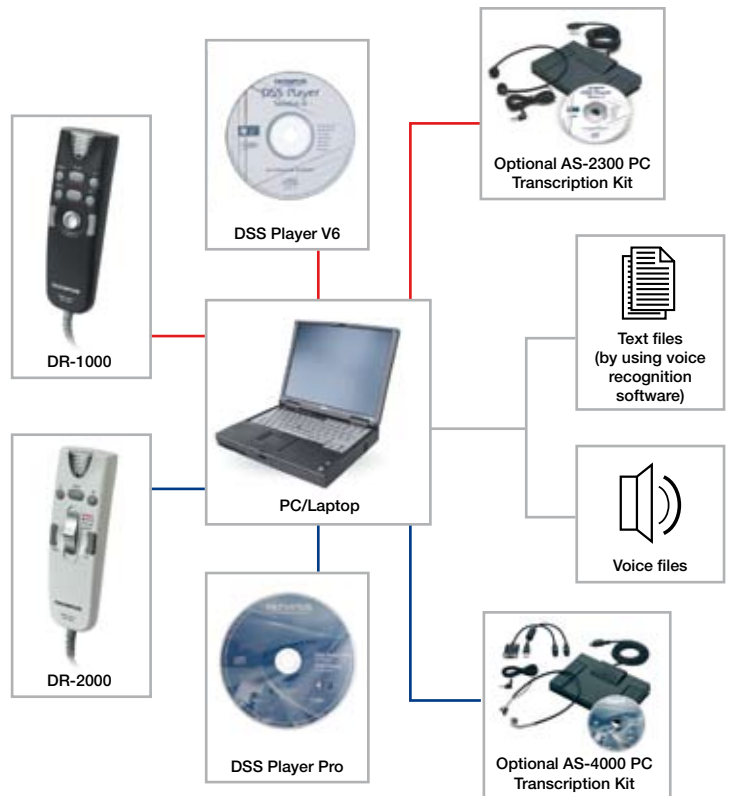

Directrec Specifications

Feature	DR-1000	DR-2000
Fast forward button	Yes	Yes
Rewind button	Yes	Yes
New button	Yes	Yes
Programmable buttons	2 – Rear/A	3 – Rear/A/B
Record button	Yes	On Slide Switch
Stop button	No	On Slide Switch
Play button	Yes	On Slide Switch
Review button	No	On Slide Switch
Recording time	Unlimited – records directly to PC	
Recording format (with DSS player)	DSS (Digital Speech Standard)	
Recording format (without DSS player)	PCM format	
Power switch	No	No
Slide switch	No	Yes
Pointer	Yes	No
Microphone sensitivity	- 61dB at 1kHz (Dict) / - 48dB at 1kHz (Conf)	
Optional accessories	AS-2300 (Dict. kit only)	AS-4000 (Exec. kit only)
Software	Dict. kit comes with DSS Player V6	Exec. kit comes with DSS Player-Pro
Plug shape	USB A Type	
Interface	USB Audio Class/HID Class	
Overall frequency response	100 to 15,000Hz	
Maximum working output (5V DC)	300mW or more (8 ohm speaker)	
Microphone diameter	10mm	
Speaker diameter	36mm	
Transfer data	PCM, 16 bit, mono	
Sampling rate	8, 11, 12, 16, 22, 44kHz	
Input level	- 70dBv	
Dimension (LxWxT) mm	157 x 49 x 27mm (without protrusions)	
Cord length	2.5m	
Weight	110g (excluding cable)	

PC Requirements – DR Kits

IBM PC/AT compatible PC
 Microsoft Windows Me/2000 Professional, XP Professional, Home Edition
 Intel Pentium II class 333 MHz processor or faster (Processor 500MHz or faster is recommended)
 128MB or more (256MB or more is recommended)
 50MB or more HDD space
 2 x or faster CD-ROM, CD-R, CD-RW, DVD-ROM drive
 Creative Labs Sound Blaster 16 or 100% compatible sound card
 Microsoft Internet Explorer 4.01 SP2 or later
 800 x 600 pixels or more, 256 colours or more
 One or more free ports

PC Requirements – DR Only

IBM PC/AT compatible PC
 Microsoft Windows Me/2000 Professional, XP Professional, Home Edition
 Intel Pentium II class 166 MHz processor or faster (Processor 500MHz or faster is recommended)
 One or more free ports

Both the DR-2000 and DR-1000 are available to buy separately for full integration into workflow systems.

OLYMPUS IMAGING EUROPA GMBH
 Wendenstr. 14-18, D-20097 Hamburg, Germany
 P.O. Box 10 49 08, D-20034 Hamburg, Germany
 Phone +49 40 23773-0
 Fax +49 40 23773-272
 www.olympus-europa.com

OLYMPUS
 Your Vision, Our Future